

GRAPHIC TOUCHSCREEN KEYPADS

Quick Reference Guide

All/Perimeter System

Arm

1. Press the homescreen shield in the center of the keypad.
2. Select **ALL** to arm all areas or **PERIM** to arm only the perimeter.
3. At **ENTER CODE**, enter a user code at the keypad or present a credential to the proximity reader.

Disarm

1. Press the homescreen shield in the center of the keypad.
2. At **ENTER CODE**, enter a user code at the keypad or present a credential to the proximity reader.

Touchless Arming

Present a credential to the built-in reader to automatically arm the system without touching the keypad. After the arming delay expires, All/Perimeter systems arm All. Home/Sleep/Away and Home/Away systems arm Away. Requires keypad firmware Version 205 and higher.

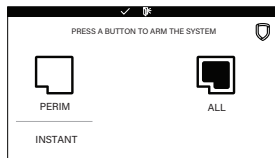
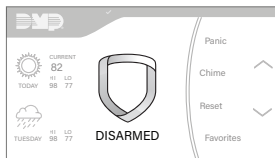

Home/Sleep/Away System and Home/Away System

Arm

1. Press the homescreen shield in the center of the keypad.
2. Select **HOME** to arm the perimeter, select **SLEEP** to arm everything except the bedroom areas, or select **AWAY** to arm all areas. The arm sleep option is not available on Home/Away systems.
3. At **ENTER CODE**, enter a user code at the keypad or present a credential to the proximity reader.

Disarm

1. Press the homescreen shield in the center of the keypad.
2. At **ENTER CODE**, enter a user code at the keypad or present a credential to the proximity reader.

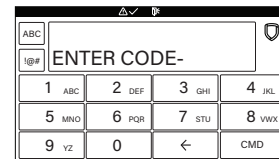
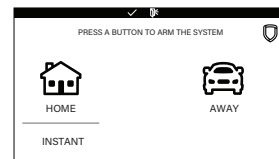
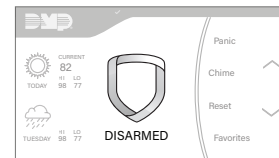

GRAPHIC TOUCHSCREEN KEYPADS

Quick Reference Guide

Area System

Arm or Disarm

1. Press the homescreen shield in the center of the keypad. Select **ARM** or **DISARM**.
2. At **ENTER CODE**, enter a user code at the keypad or present a credential to the proximity reader.
3. To arm or disarm only selected areas select **NO** at **ALL? NO YES**. To arm or disarm all areas authorized for your user code, select **YES**.
4. When you select **NO**, the display lists each authorized area for your user code followed by **NO YES**.
 - Select **NO** for each area you do not want to arm or disarm.
 - Select **YES** for each area you want to arm or disarm.

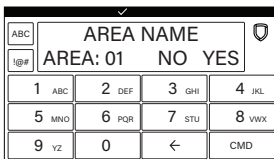



Clean the Keypad

The Clean Keypad Screen option locks the screen for 40 seconds so you can clean it without accidentally pressing buttons.

Use gentle pressure to clean the display, screen, keys, and housing. Use only alcohol sprays or wipes that contain 70% isopropyl alcohol to clean keypad surfaces.

Avoid spraying cleaner directly onto the keypad, oversaturating cleaning cloths, or allowing cleaner to make contact with internal electronic components, cables, or power sources.

1. In the Carousel Menu, tap **Options**.
2. Tap  Clean Keypad Screen.
3. Use an alcohol wipe or spray a small amount of rubbing alcohol onto a clean, dry microfiber cloth to gently wipe down all keypad touch surfaces, removing any excess cleaner.
4. Wait 10 seconds, then completely dry all keypad surfaces.
5. If necessary, use a clean, dry microfiber cloth to gently remove streaking.

After the countdown timer expires, the keypad returns to normal operation. To exit the countdown early, press and hold the  Shield icon for 2 seconds.

