

695-7800-WLNX-W BACKBOX

Installation Guide

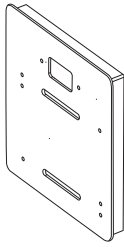

Figure 1: 695-7800-WLNX-W Backbox

DESCRIPTION

The 695-7800-WLNX-W Backbox is a mounting option for the 7873/7873H Series Graphic Touchscreen Keypads and WaveLynx Ethos 10 Mullion Reader.

Compatibility

- 7873/7873H Series Graphic Touchscreen Keypads
- WaveLynx ET10 Mullion Reader

What is Included?

- One 695-7800-WLNX-W Backbox
- Four #6 1" Screws
- Two 6-32 0.5" Machine Screws



1

CHOOSE THE ORIENTATION OF THE KEYPAD AND READER

You can install the backbox to display the keypad above or below the reader. Refer to Figure 2 for display options.

Keypad Above Reader

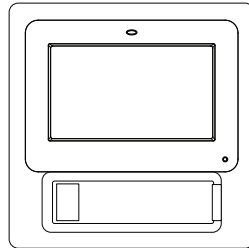

Keypad Below Reader

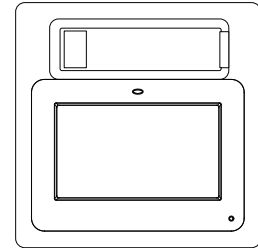

Figure 2: Display Options

2

MOUNT THE BACKBOX

1. Secure the template in Figure 7 or 8 to the wall. Ensure the height of the reader will comply with ADA standards once installed.
2. Cut along the wiring cutout line to create a hole in the wall for the wires.
3. Drill holes in the wall at the mounting hole marks.
4. Remove the mounting template and secure the backbox to the wall with the four #6 1" provided screws. Use wall anchors as needed. Refer to Figure 3.
5. Route the wires from the wall through the wiring cutout in the backbox.

Keypad Above Reader

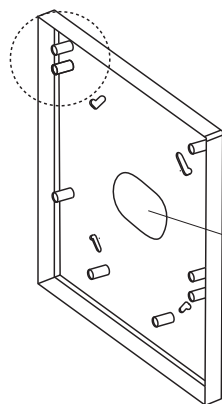

Keypad Below Reader

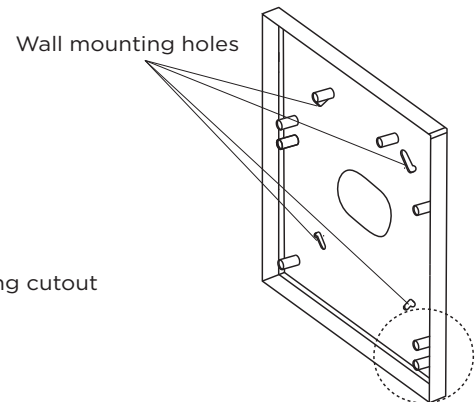

Figure 3: Backbox Orientation

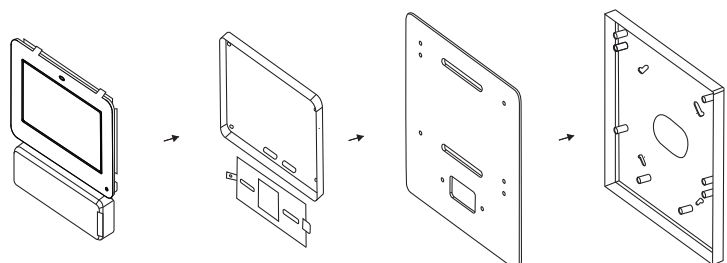

Figure 4: Installation Overview (From Right to Left)

3 ATTACH THE MOUNTING PLATE TO THE BACKBOX

Refer to Figure 5 as needed to complete the following steps:

1. Route the wires from the wall through the wiring cutouts in the mounting plate.
2. Secure the mounting plate to the backbox with the two 6-32 0.5" provided machine screws.

Keypad Above Reader

Keypad Below Reader

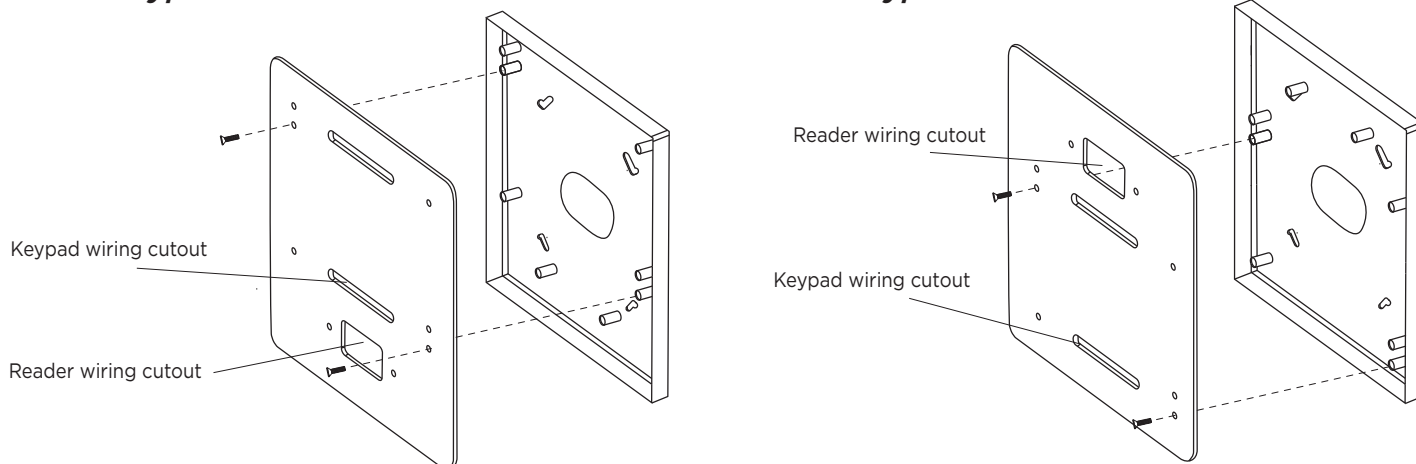

Figure 5: Mounting Plate Diagram

4 MOUNT THE KEYPAD TO THE MOUNTING PLATE

Refer to the keypad installation and programming guide as needed.

1. Remove the front cover of the keypad.
2. Route the keypad wires through the wiring cutouts on the keypad base.
3. Secure the keypad base to the mounting plate using the screws provided with the keypad. Refer to Figure 6.
4. Wire the keypad, then push the wires back into the wall.
5. Snap the keypad cover onto the keypad base.

5 MOUNT THE READER TO THE MOUNTING PLATE

Refer to the reader installation guide as needed.

1. Secure the reader metal wall plate to the mounting plate using the screws provided with the reader. Refer to Figure 6.
2. Wire the reader, then push the wires back into the wall.
3. Slide the reader onto the plate and secure it with the screw provided with the reader.

Keypad Above Reader

Keypad Below Reader

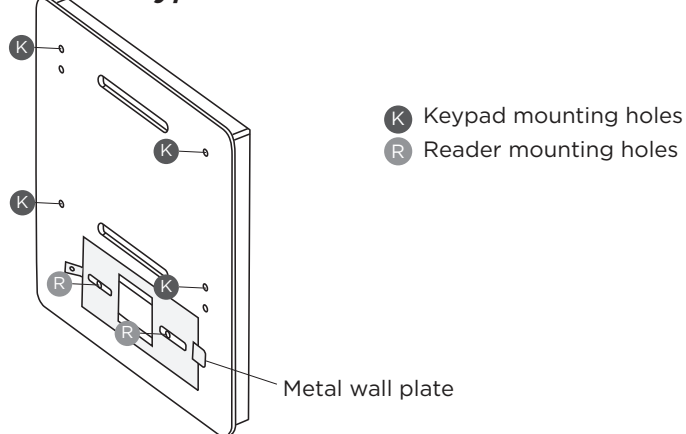

Figure 6: Keypad and Reader Mounting Holes

PRINT TEMPLATE ACTUAL SIZE.

Keypad Above Reader

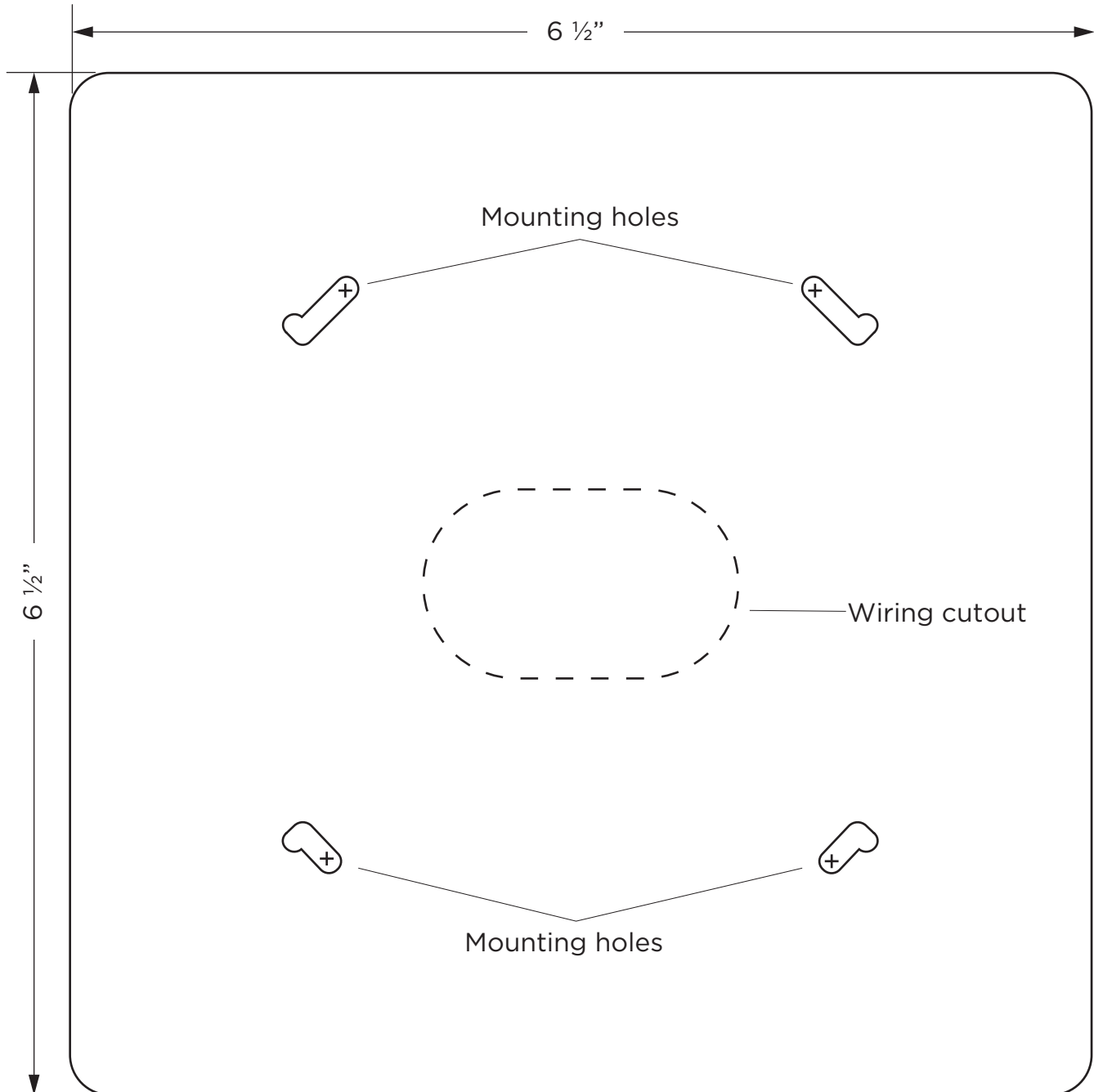

Figure 7: Mounting Template Option 1

PRINT TEMPLATE ACTUAL SIZE.

Keypad Below Reader

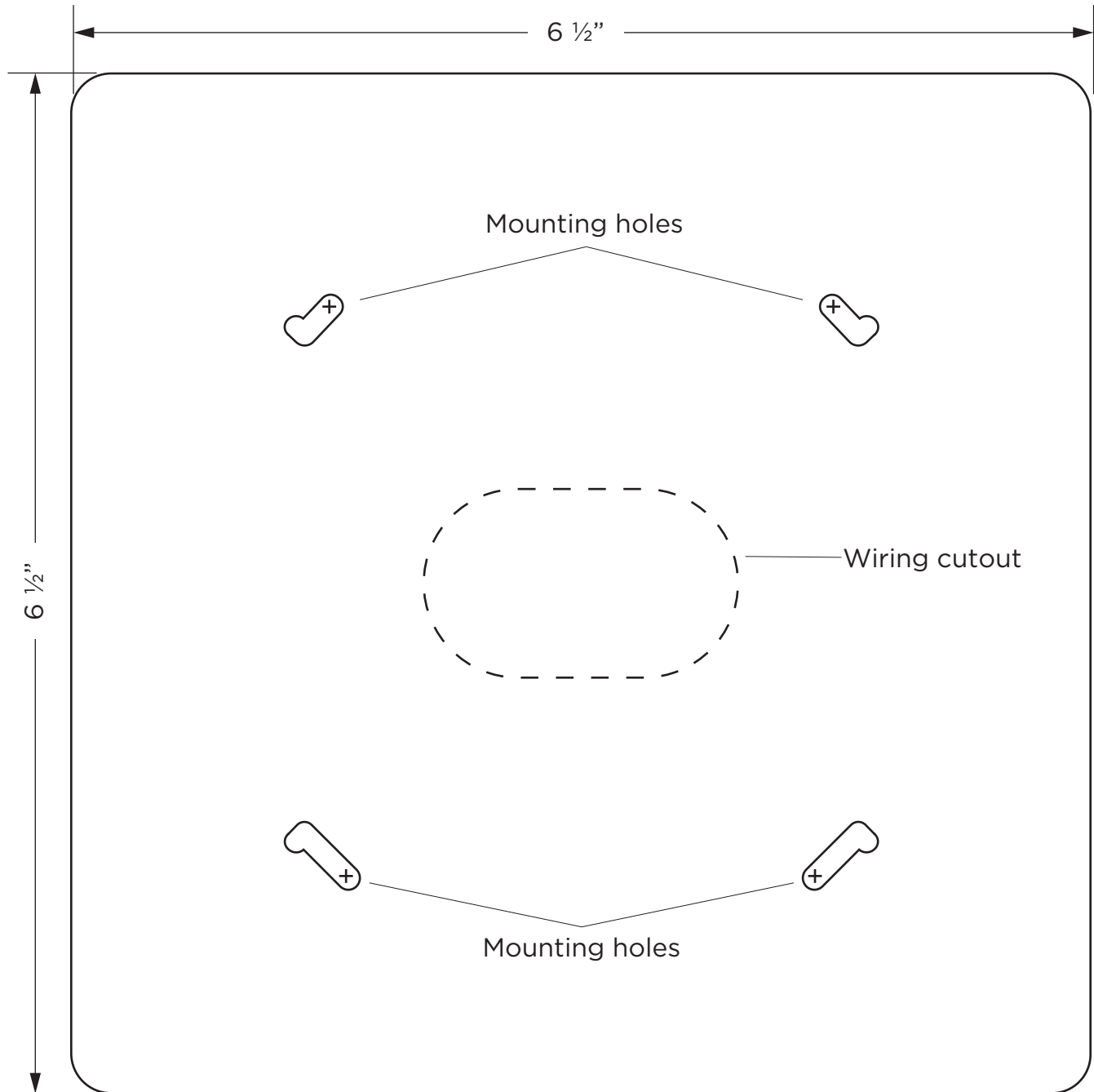

Figure 8: Mounting Template Option 2

695-7800-WLNX-W BACKBOX



Specifications

Dimensions (assembled backbox)	7.045" W x 7.045" H x 0.9" D 17.894 cm W x 17.894 cm H x 2.286 cm D
--------------------------------------	--

Dimensions (backbox only)	6.48" W x 6.48" H x 0.775" D 16.459 cm W x 16.459 cm H x 1.967 cm D
Dimensions (mounting plate)	7.045" W x 7.045" H x 0.125" D 17.894 cm W x 17.894 cm H x 0.318 cm D
Material	Steel backbox and Acrylic Plastic mounting plate

Ordering Information

695-7800-WLNX-W



Designed, engineered, and
manufactured in Springfield, MO
using U.S. and global components.

LT-2846 24142

INTRUSION • FIRE • ACCESS • NETWORKS

2500 North Partnership Boulevard
Springfield, Missouri 65803-8877
800.641.4282 | DMP.com