

## FEATURE UPDATE | APRIL 2021

### New Features

Effective April 20th, 2021, Tech APP is updated to Version 2.15.0.

#### SR3 Bluetooth and Proximity Reader Enrollment

Tech APP now enables you to enroll and associate SR3 Bluetooth Readers into a customer's system during installation. You can also configure reader settings like adjusting the read range and updating the reader's firmware.

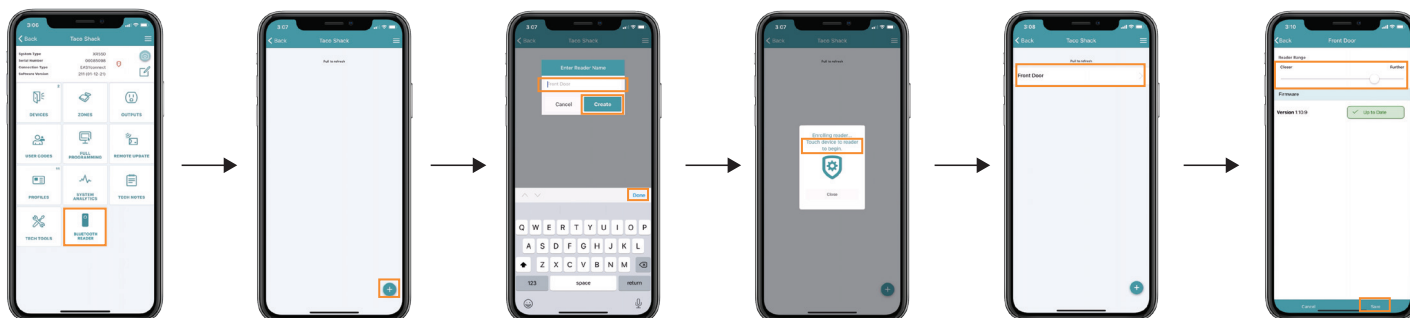

### Compatibility and Requirements

#### Reader Compatibility

Mobile Credentials are designed for the [SR3 Bluetooth and Proximity Reader](#).

#### Purchasing and Issuing Credentials

Requires either an X1 Series door controller or any Dealer Admin-compatible panel with an access control module or keypad.

You must have an **Administrator** role or a custom role with **Mobile Credential** permissions to purchase credentials in Dealer Admin.

#### Reader Enrollment and Association

Requires mobile device with either iOS version 10.0 and higher or Android version 8.0 (Oreo) and higher. Devices must also have the latest version of Tech APP installed and Bluetooth enabled.

#### Using Credentials

Credentials are assigned to users in Virtual Keypad. Using credentials at a reader requires a mobile device with minimum BLE 4.2 and iOS version 10.0 or Android version 8.0 (Oreo). Devices must also have the latest version of Virtual Keypad installed and Bluetooth enabled.

To safeguard customer security, a technician device may not have both an enrollment authorization token from Tech APP and a mobile credential from Virtual Keypad.

### More Information

To learn more, refer to the following documentation:

- [SR3 Bluetooth and Proximity Reader Installation Guide \(LT-2505\)](#)
- [Tech APP Help: Bluetooth Reader Enrollment](#)